

Relocate

If you have already identified one element in the current project, and want to import another drawing to continue the identification, but you find that the identified element does not completely overlap with the drawing, you can use this function to locate the drawing again.

1. Click **Relocate**, and then select one point in the current CAD drawing as the base point.

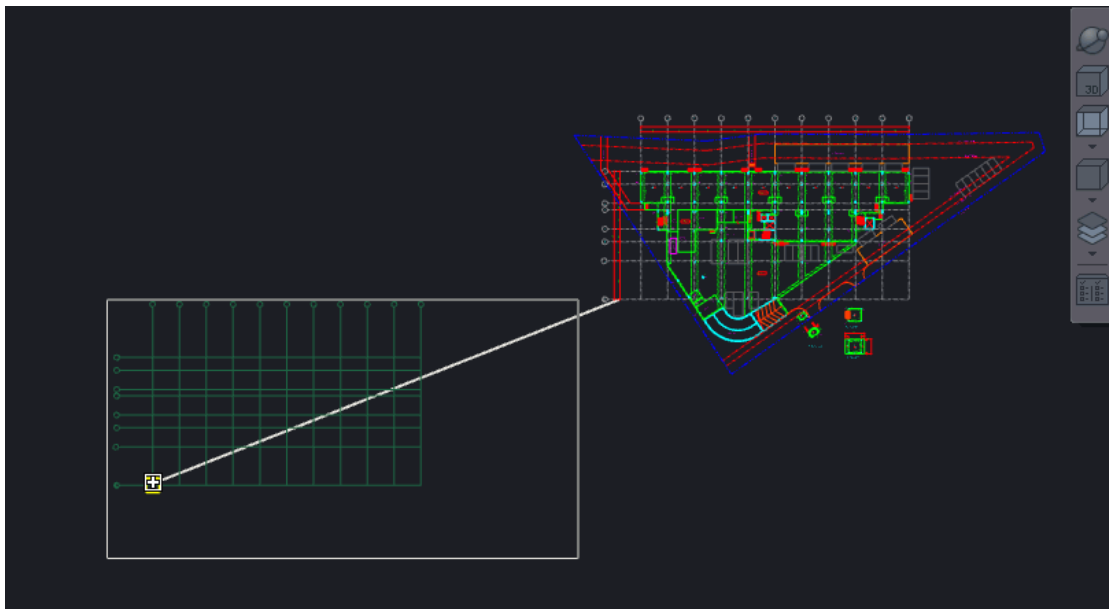

2. Specify another point as the target point, and then right click to confirm.

Cubicost- TAS C

